

**SPECIFICATION**

- Nominal capacity 100mA @150°C 4200mAh
- Nominal voltage 3.6V
- Max continuous discharge current 100mA
- Weight 55g
- Volume 24cc
- Operate temperature -20~150°C

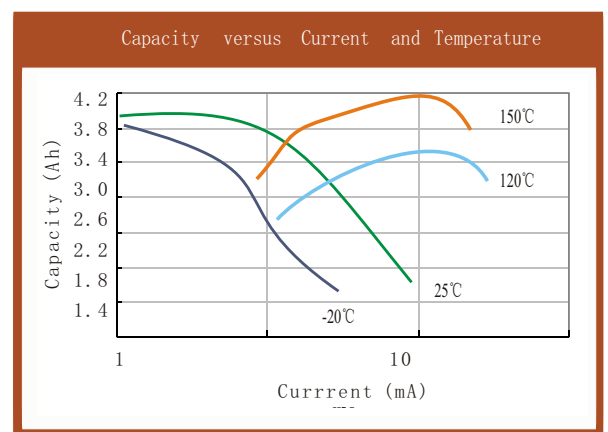
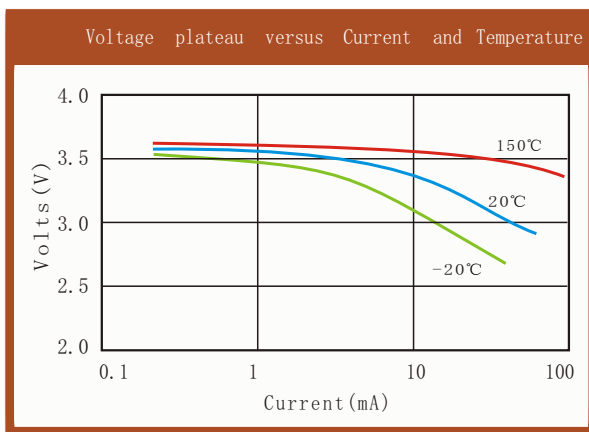
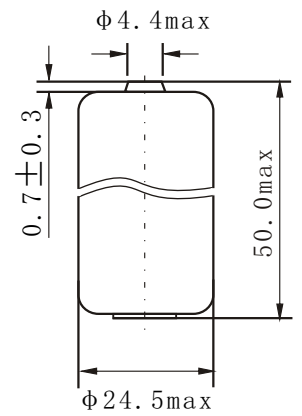
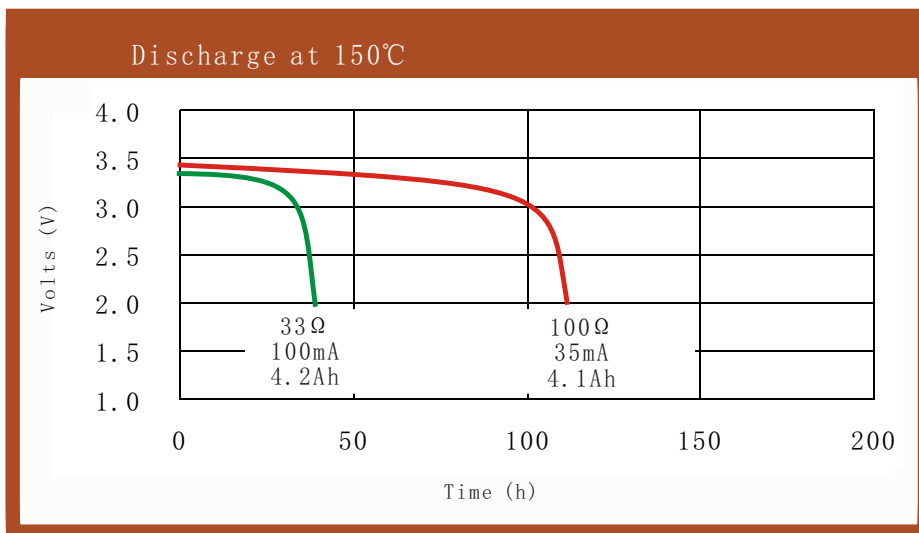

**WARNING:** Risk of fire and burn. Do not recharge, disassemble, heat above 100°C or incinerate. Do not mix fresh batteries with used batteries.  
**\*\*Note:** The data in this document are for descriptive purposes only and subject to change without prior notice.